

Easy Plumbing Fixes



Estimated Water Savings

A family of 4 could save:

- 200 gpd by fixing **toilet leaks**
- 20 gpd by fixing **faucet leaks**
- 100 gpd by installing **low-flow showerheads**
- 40 gpd using **faucet aerators**



gpd = gallons per day

Checking/Testing for Water Leaks

- Check your winter water use
 - A family of four might have a leak if winter water use exceeds 12,000 gallons per month
- Check your water meter before and after a two-hour period when no water is being used.



Checking/Testing for Water Leaks

Click [HERE](#) for a video on how to check for leaks, read you water meter and turn off your home's water at the meter.

Replacing a Toilet Flapper

Tools/Materials Needed:

- Channel lock or Crescent wrench
- Flapper Valve



Replacing a Toilet Flapper

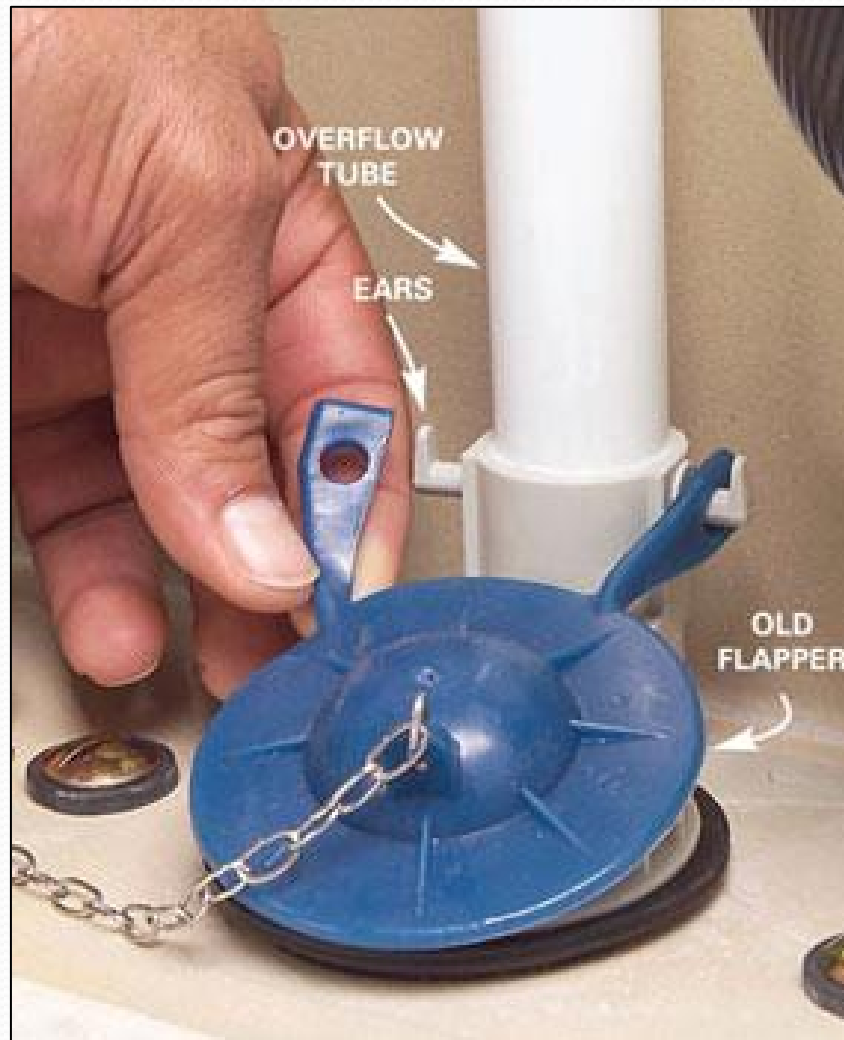

Replacing a Toilet Flapper

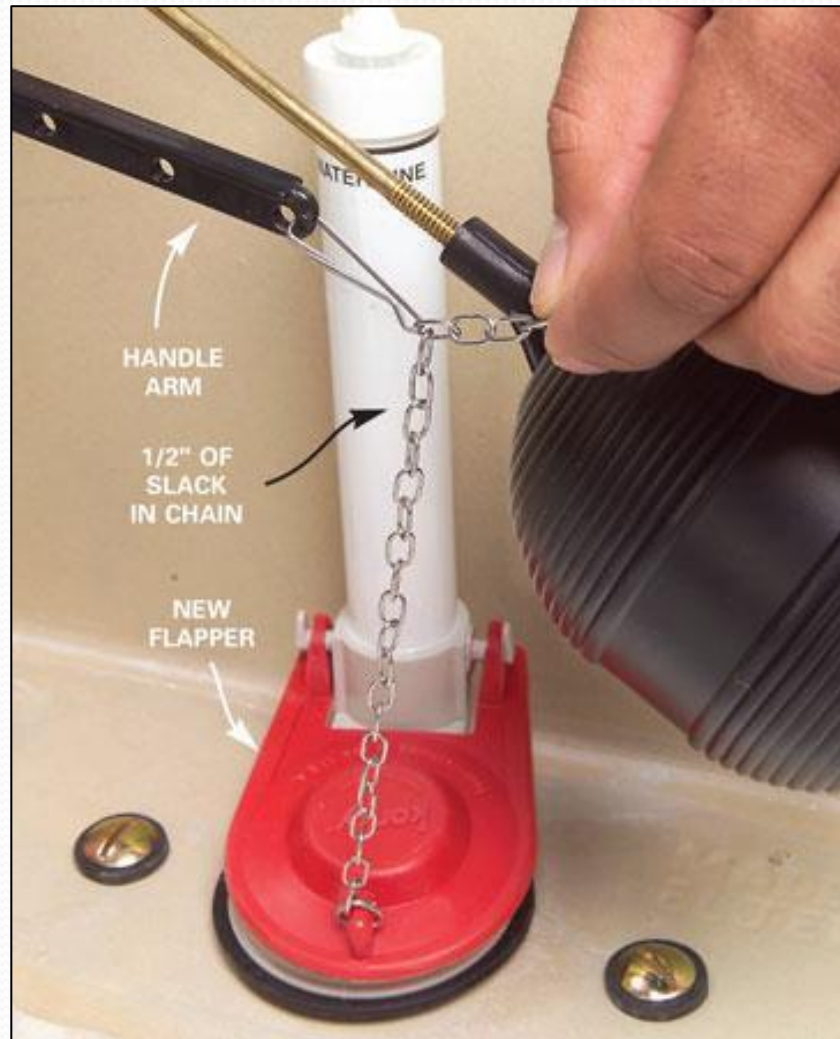

Replacing a Toilet Flapper

Click [HERE](#) for a video tutorial on how to replace a toilet flapper.

Replacing a Toilet Fill Valve

Tools/Materials Needed:

- Channel lock
- Fill Valve



Replacing a Toilet Fill Valve



Turn off the water supply, flush the toilet, and sponge the remaining water from the tank.

Disconnect the water supply line, unscrew the fill valve locknut.



Replacing a Toilet Fill Valve



Replacing a Toilet Fill Valve



Prepare the new fill valve by adjusting the height of the fill valve as necessary.

TIP: You want the fill valve to be slightly taller than the over flow tube but not so tall that it will prevent the tank lid from closing.

Replacing a Toilet Fill Valve



- Set the fill valve into the toilet tank.
- Make sure the nipple is facing the overflow tube.
- Tighten the nut under the toilet tank by hand until firm.
- Then use pliers to tighten just a little more.

Replacing a Toilet Fill Valve

- Cut rubber hose to length and connect to the fill tube.
- Clip onto the overflow pipe.
- Turn water back on and check for leaks under the toilet tank.
- Adjust the water level appropriately for your toilet. The tank should fill to marked water line.

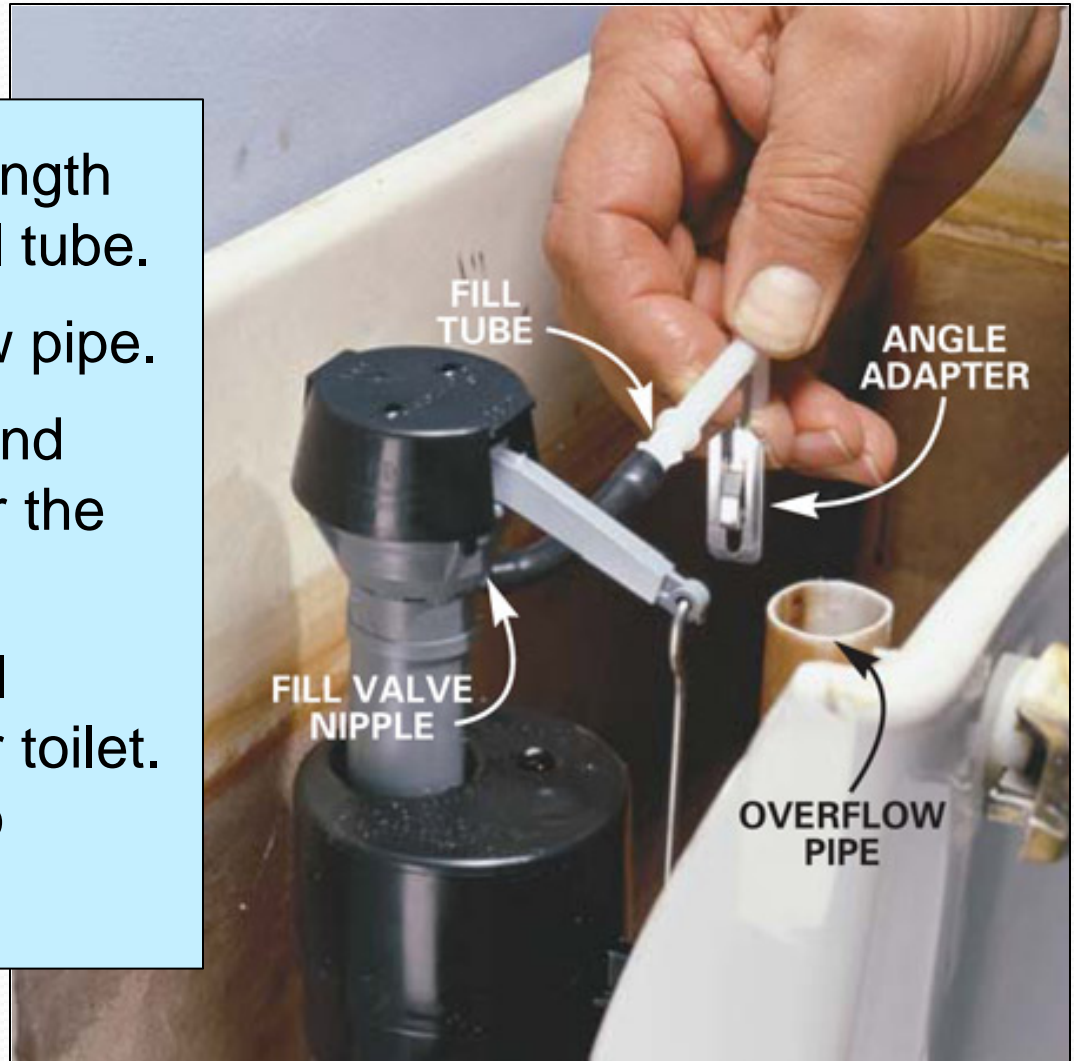

Installing a Low-Flow Showerhead

Tools/Materials Needed:

- Channel lock
- Rag/towel
- Low-flow showerhead
- Teflon tape



Installing a Low-Flow Showerhead

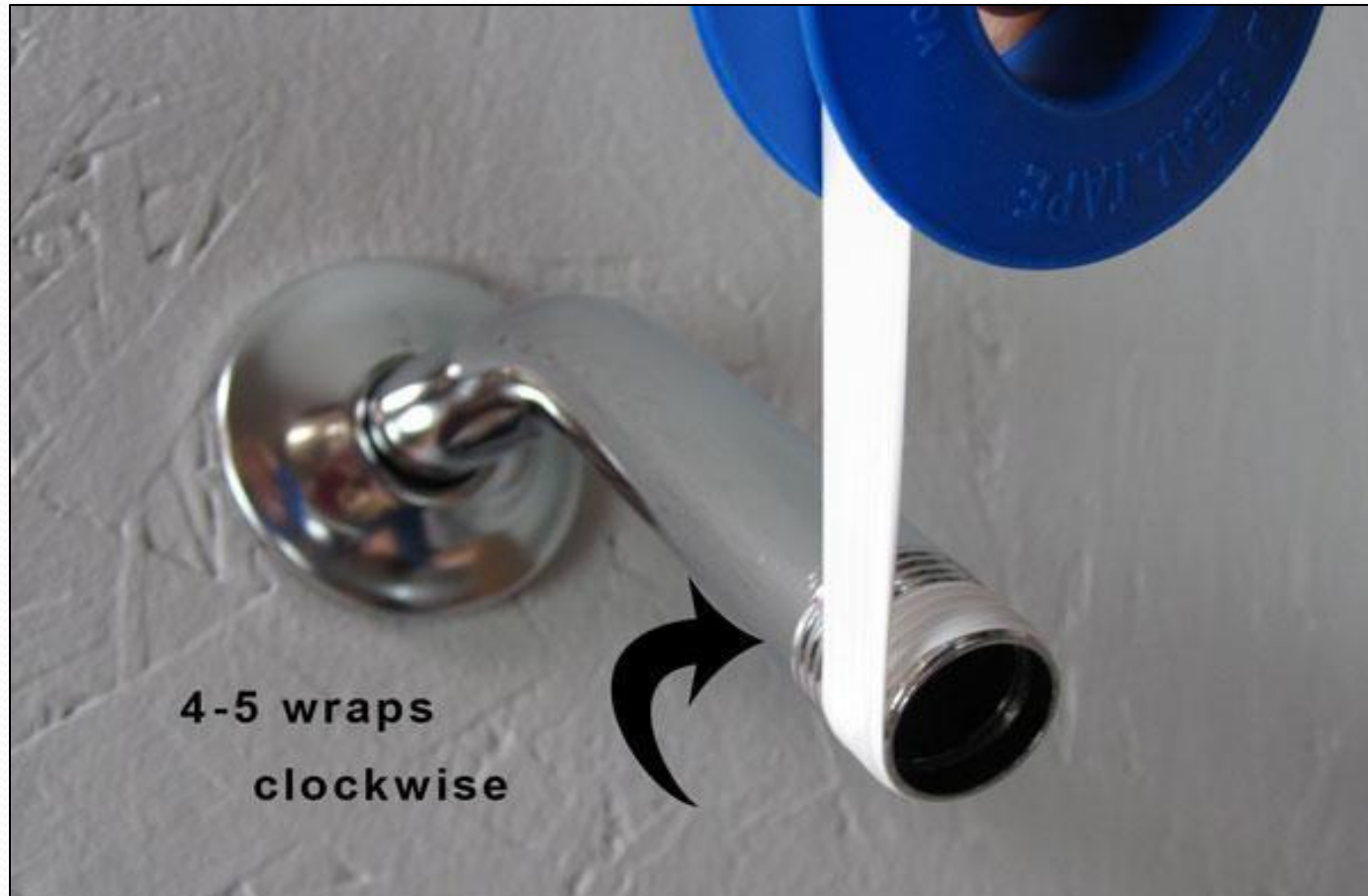

Wrap Teflon tape around shower arm threads 4 – 5 times in a clockwise direction.

Installing a Low-Flow Showerhead



Installing a Low-Flow Showerhead



Installing a Low-Flow Showerhead

Click [HERE](#) for a video tutorial on how to install a low-flow showerhead.

Fixing a Leaky Faucet

Tools/Materials Needed:

- Channel lock
- Allen wrench set
- Phillips screwdriver
- Faucet cartridge/washer



Fixing a Leaky Faucet



Fixing a Leaky Faucet



Fixing a Leaky Faucet



Fixing a Leaky Faucet

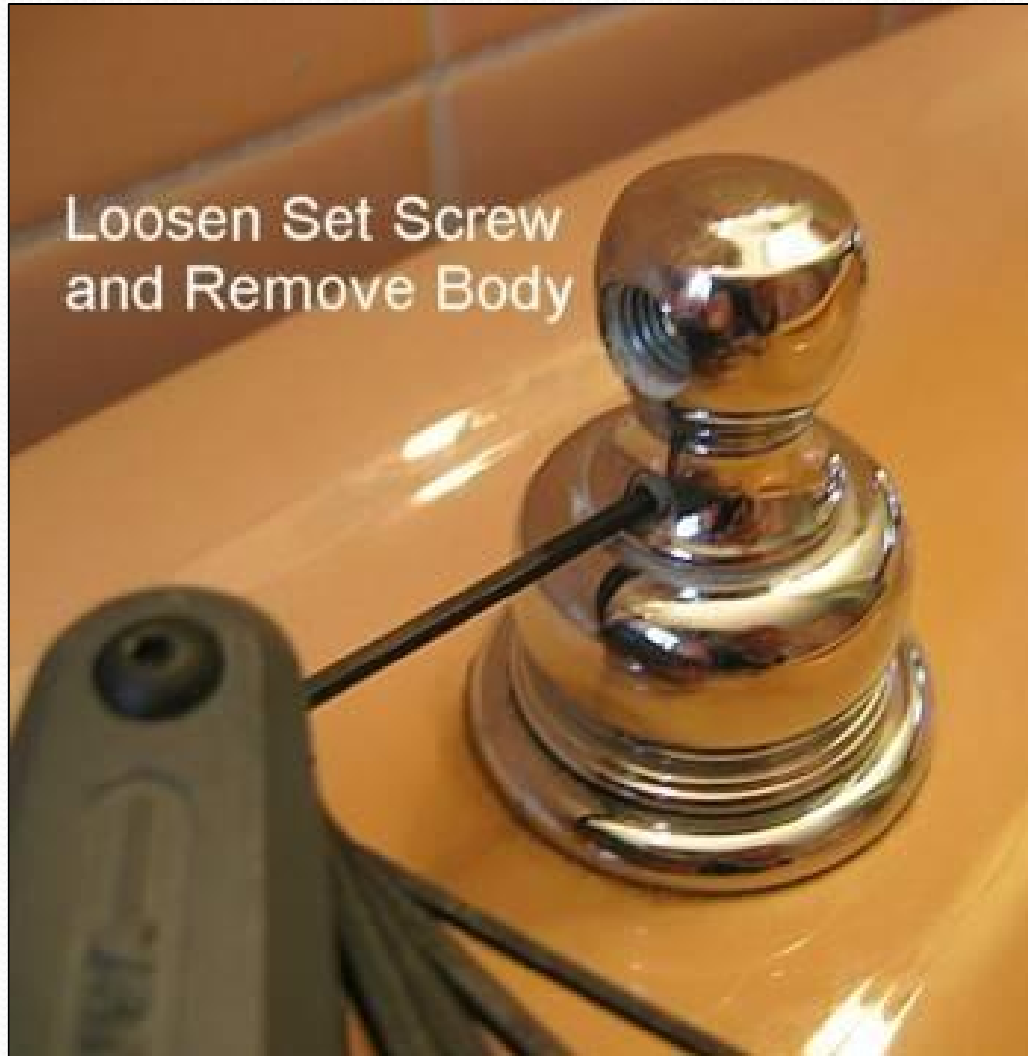

Fixing a Leaky Faucet



Loosen retaining ring and remove.

Fixing a Leaky Faucet



Fixing a Leaky Faucet



Faucet Cartridge

Take this part to a plumbing supply store to match the exact model.

Fixing a Leaky Faucet



Fixing a Leaky Faucet

Click [HERE](#) for a video tutorial on how to fix a leaky faucet.

Installing an Aerator

Tools/Materials Needed:

- Channel lock/Crescent wrench
- Rag/Towel
- Aerator

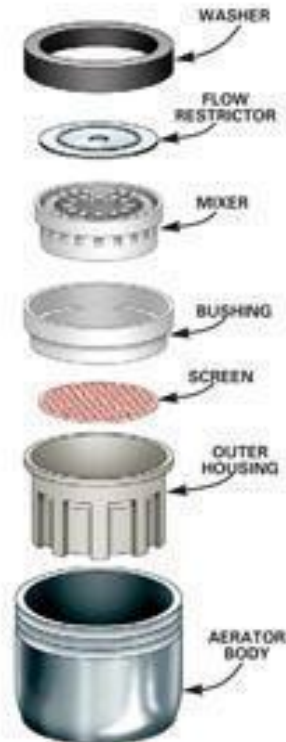

Installing an Aerator



Remove existing aerator if replacing. Use channel locks or crescent wrench to loosen.

Installing an Aerator



Install new aerator and tighten by hand. Use channel locks or crescent wrench to tighten once quarter turn more.

Installing an Aerator

Click [HERE](#) for a video tutorial on how to install a faucet aerator.

Fixing a Leaky Hose Bib

Tools/Materials Needed:

- Channel lock/Crescent wrench
- Phillips screwdriver
- Packing nut/washer



Fixing a Leaky Hose Bib

Click [HERE](#) for a video tutorial on how to fix a leaking hose bib (outdoor faucet).



Repairs that may require a plumber...

- Toilet replacement
- Water heaters
- “Sweating” copper pipes
- More substantial leaks



Plano Water Conservation Programs

Indoor

- Free Water Conservation Retrofit Items
- Toilet Rebate Program

Outdoor

- Rain/Freeze Sensor Rebate
- Rain Barrel Rebate
- Summer classes & workshops
livegreeninplano.obsres.com



Questions?

- Details on water conservation programs, including rebates & free items visit plano.gov/water
- Questions about your bill or water use?
Customer & Utility Services 972-941-7105
- Upcoming class schedule & registration livegreeninplano.obsres.com